

CORRER

Roldana Strong Fit c/rol.c/reg. simples /dupla

COMPOSIÇÃO

Cavalete, suporte e eixo da roda alumínio
 Roda com rolamento delrin/aço
 Guias e buchas poliamida
 Parafusos de fixação 4,8 x 16 Inox
 Parafusos de regulagem M6 x 25 Inox

INFORMAÇÕES

Unidade de comercialização Unitário

EMBALAGEM:

02 pçs

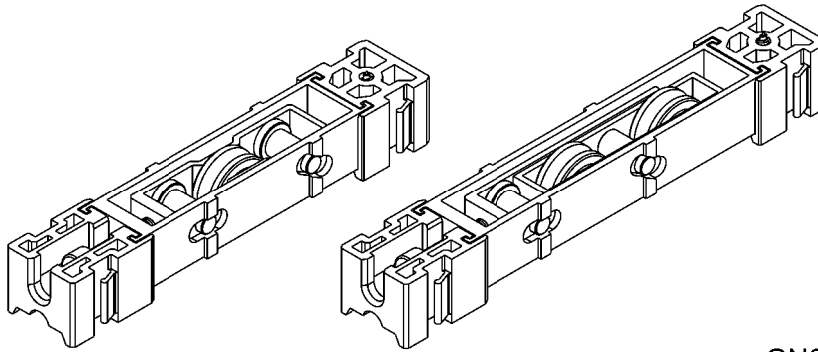

ROL136 simples (150 Kg/folha)
 ROL161 dupla (300 Kg p/folha)

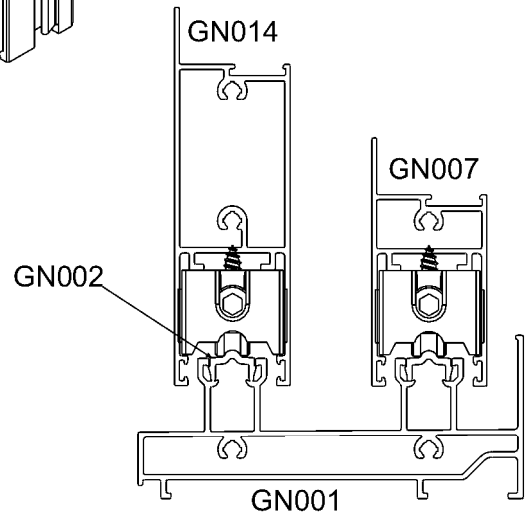

Nova Gold (Hydro Sapa)
 Instalação: escala 1:2

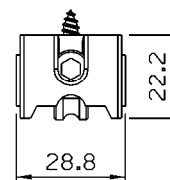
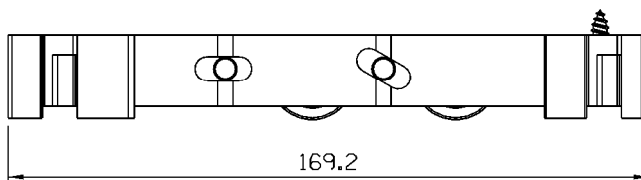
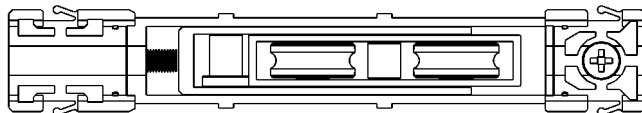
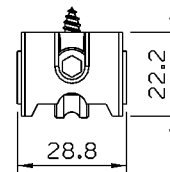
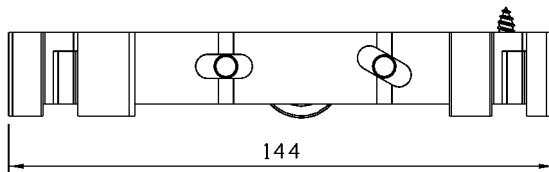
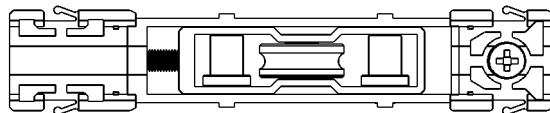

Vistas: escala 1:2